

Product data sheet

Specifications



90° fixing bracket, Photoelectric sensors XU, accessory for sensor, Ø 18 mm, stainless steel

XUZA118

Product availability : Stock - Normally stocked in distribution facility

Main

Range of Product	Telemecanique Photoelectric sensors XU
Accessory / separate part category	Mounting and fixing accessory
Accessory / separate part type	Fixing bracket
Product or Component Type	Fixing bracket
Operating angle	90 °
Accessory / separate part destination	sensor Ø 18 mm
Material	Stainless steel

Complementary

Product Compatibility	XU.
Net Weight	0.10 lb(US) (0.045 kg)

Ordering and shipping details

Category	22499-SENSORS ACCESSORIES
Discount Schedule	DS2
GTIN	3389110704723
Returnability	Yes
Country of origin	FR

Packing Units

Unit Type of Package 1	PCE
Number of Units in Package 1	1
Package 1 Height	1.14 in (2.9 cm)
Package 1 Width	1.42 in (3.6 cm)
Package 1 Length	1.97 in (5.0 cm)
Package 1 Weight	1.34 oz (38.0 g)
Unit Type of Package 2	S01
Number of Units in Package 2	100
Package 2 Height	5.91 in (15.0 cm)

Package 2 Width	5.91 in (15.0 cm)
Package 2 Length	15.75 in (40.0 cm)
Package 2 Weight	8.70 lb(US) (3.946 kg)

Offer Sustainability

Sustainable offer status	Green Premium product
California proposition 65	WARNING: This product can expose you to chemicals including: Diisononyl phthalate (DINP), which is known to the State of California to cause cancer, and Di-isodecyl phthalate (DIDP), which is known to the State of California to cause birth defects or other reproductive harm. For more information go to www.P65Warnings.ca.gov
REACH Regulation	REACH Declaration
EU RoHS Directive	Pro-active compliance (Product out of EU RoHS legal scope) EU RoHS Declaration
Mercury free	Yes
RoHS exemption information	Yes
Environmental Disclosure	Product Environmental Profile
Circularity Profile	End of Life Information

Contractual warranty

Warranty	18 months
----------	-----------

Product data sheet

Dimensions Drawings

XUZA118

Dimensions

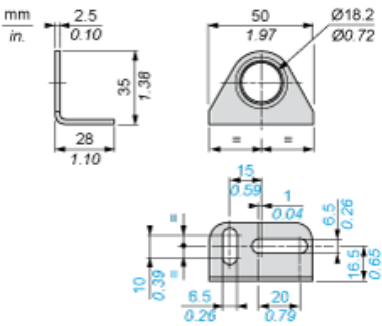

Recommended replacement(s)